

BBQ Guru Adaptor Door w/ Inducer Sleeve

Expansion Clip

Original BGE/Primo Draft Door

Stop Tab



*Draft door track shown removed from cooker for clarity.*

Note: There is no need to remove the original Mfg. draft door.

Step 1.



Place Expansion Clip onto the top of BBQ Guru Adaptor Door.

Step 2.



With the BBQ Guru logo in the bottom left corner, push the expansion clip and Guru adaptor door into the top track.

Step 3.

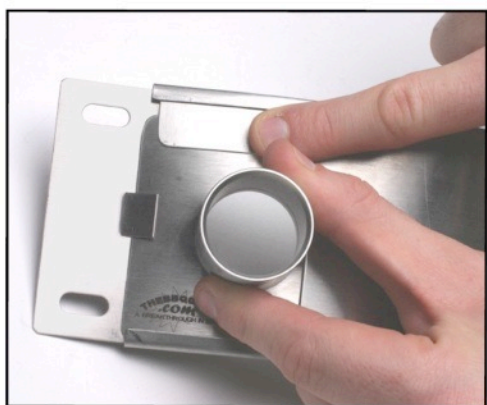

While holding the expansion clip in place in the top track, grip the inducer sleeve and pull down until the Guru adaptor door engages the bottom track. Push the Guru adaptor door to the left and under the stop tab.

Step 4.



Close the original Mfg. draft door **OVER** the top of the Guru adaptor door until the leading edge touches the inducer sleeve and the expansion clip moves all the way to the left. (Reverse order to remove.)